



Part No: 2920-5000

## Introduction

2920-5000 is a high performance proximity card reader and digital keypad:

- Dual relay outputs:  
ZONE 1: lock operation, door status detection, egress button functions.  
ZONE 2 doorbell/button functionality.
- Capacity for 1000 passwords and card holders (ZONE 1) and up to 10 passwords or card holders (ZONE 2).
- Built-in tamper function, watchdog timer, and a powerful reboot and self-recovery watchdog which can be connected to an external unlock button.
- Can be operated for card access only, card or password access or combined access.
- 5cm read range.
- Operates at 125kHz.

## Specifications

<b>Temperature range</b>	-20°C to +50°C
<b>Humidity range</b>	5-95% non-condensing
<b>Power</b>	12 - 24V DC; 12- 24 V AC
<b>Current</b>	80mA (standby); 110mA (working)
<b>Card Read Range</b>	Up to 50 mm
<b>Operating Frequency</b>	125kHz
<b>Capacity</b>	ZONE 1: 1000 passwords AND cards; ZONE 2: 10 passwords OR cards
<b>Dimensions</b>	165 (H) x 45 (W) x 23.5 (D) mm
<b>Weight</b>	0.54kg

## Mounting

1. Open the controller by removing the back case screw at the bottom with the supplied spline tool.
2. Use the screws provided to mount the back case to the wall. Be sure to draw the wiring through the large central hole in the back case, and keep level.
3. Use the provided template to accurately locate and drill the required holes.
4. Connect all wires as described opposite and on the labelling guide on the back of the unit.
5. Put the unit onto the back cover and fasten in place.

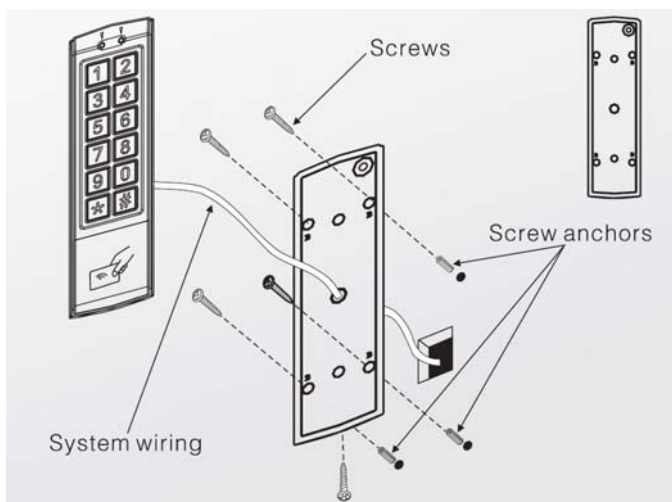

## Connection

Colour	Use	
Red	+ AC or DC input - 12V – 24V	<b>POWER IN</b>
Black		
Brown	Door sense	<b>ZONE 1</b>
Orange	Button: egress	
White	Lock: Normally open	
Pink	Lock: Common	
Aqua	Lock: Normally closed	
Yellow	Button: doorbell	<b>ZONE 2</b>
Blue	Bell: Normally open	
Purple	Bell: Common	
Grey	Bell: Normally closed	
Green	Ground for door sense, egress button and doorbell button	<b>GNDs</b>
Shield	Chassis ground	

For technical assistance, contact TDSi Support:

Email: [support@tdsi.co.uk](mailto:support@tdsi.co.uk)

Phone: +44(0) 1202 724998

# Settings

## Settings Mode

To access the settings mode, enter the administrator's code (default 1234) twice. The keypad emits a long beep and the mode LED turns orange.

To exit settings mode, press #. The keypad automatically exits settings mode after 30s of inactivity

You can also use an administrator's master card (see below) to enter and exit settings mode.

## Set the Admin Password

Having entered settings mode, press \* and then 3. The mode LED flashes orange.

Enter a new password of the correct length (default: 4 digits). Type the password again to confirm. The keypad emits a long beep and the mode LED turns orange.

## Set the Password Length

**NOTE: CHANGING THIS SETTING CLEARS ALL EXISTING CARDS AND PASSWORDS**

Having entered settings mode, press \* and then 9. The mode LED flashes orange. Press 0 and then 4. Enter required length of code: 2 to 6.

## Reset the Admin Password

Switch unit off. Switch on whilst holding down # key. Code is 123456 truncated to set password admin code length (see above).

## Set User Access Mode

Having entered settings mode, press \* and then 0. The mode LED flashes orange. Set the required mode as follows:

Card access only	press 0 twice
Card or password access	press 0 and then 1
Card AND password access	press 0 and then 2

## Enrol Zone 1 Users

Having entered settings mode, type the user's 3-digit code (000-999). Red LED indicates number already in use, green LED: number available.

**Enrol card:** optional for *Card or password access* mode. Swipe user's card. Single beep indicates that card has been read successfully.

**Enrol password:** not available in *Card Access* mode. Type a password for the user (set digit length).

## Delete Zone 1 User

Having entered settings mode, type the user's 3-digit code (000-999). Red LED indicates number exists. Press \* twice.

## Assign Master Card

Having entered settings mode, press \* and then 7. Swipe card.

## Delete Master Card

Having entered settings mode, press \* and then 7. Swipe card. Press \* twice

## Modify User Password

Having entered settings mode, press \* and then 9. Press 0 and then 2.

Input 3-digit user code, e.g. 005.

Enter new access code (of required length)

## Enrol Zone 2 Users

Having entered settings mode, press \* and then 4. Type the user's 2-digit code (00-99). Red LED indicates number already in use, green LED: number available.

**Enrol card:** optional for *Card or password access* mode. Swipe user's card. Single beep indicates that card has been read successfully.

**Enrol password:** not available in *Card Access* mode. Type a password for the user (set digit length).

## Delete Zone 2 User

Having entered settings mode, press \* and then 4. Type the user's 2-digit code (00-99). Red LED indicates code is valid. Press \* twice.

## Delete all Cards and Passwords (BOTH Zones)

Having entered settings mode, press \* and then 8. The mode LED flashes orange. Press 8 twice. The unit beeps four times.

## Set Door Lock Time (Zone 1 only)

Having entered settings mode, press \* and then 1. Set the unlock time in seconds: 00-99 (e.g. 05 = 5 seconds). With value of 00, user must lock door with second authentication.

## Set Door Bell Time (Zone 2 only)

Having entered settings mode, press \* and then 5. Set the operating time in seconds: 00-99 (e.g. 05 = 5 seconds).

## Enable/Disable Anti-Tamper Alarm

Having entered settings mode, press \* and then 6. DISABLE: press 0 and then 1; ENABLE: press 0 and then 2.

NOTE. If alarm is activated (due to exposure of internal sensor to light), switch off buzzer by replacing cover (60s delay) or by entering admin code.

## Enable/Disable Doorbell (Zone 2 only)

Having entered settings mode, press \* and then 2. DISABLE: press 0 and then 1; ENABLE: press 0 and then 2. NOTE. When enabled, press \* to ring bell from standby mode.

## Add a Group of Cards (Zone 1 only)

Having entered settings mode, press \* and then 9. Press 0 and then 1.

Input 3-digit starting user code, e.g. 005.

Input size of block as 3-digit number, e.g. 010 for 10 numbers/cards.

Swipe first card in block or enter card's 8-digit number. Repeat for additional cards.

## Restore Factory Defaults

Having entered settings mode, press \* and then 8. Press 9 twice.